

- 1 PROPOSED BASEMENT FLOOR PLAN**
 1 : 100
- [S] SMOKE ALARM SYSTEM
 - [MV] MECHANICAL VENTILATION
 - - - PROPOSED GROUND FLOOR OUTLINE
 - - - PROPOSED FIRST FLOOR OUTLINE

REV	DATE	DESCRIPTION	BY
A	03.02.2023	ISSUED FOR DA	DK

COPYRIGHT
 All rights reserved.
 These drawings, plans and specifications and the copyright are the property of Nemco Design and must not be used, reproduced or copied wholly or in part without the written permission of Nemco Design.

NEMCO DESIGN
 PTY LTD
 ADDRESS:
 SUITE 4 LEVEL 1,
 402-410 CHAPEL RD, BANKSTOWN,
 NSW 2209
 P: 9709 5566 M: 9422 696 228
 E: a@nemco.design.com.au

STRUCTURAL ENGINEERING
 & ARCHITECTURAL DESIGN

PROPOSED TWO STOREY DWELLING WITH BASEMENT & POOL
 50 CHASELING ST, GREENACRE
 LOT 75, DP 35156

PROPOSED BASEMENT FLOOR PLAN

JOB NUMBER: 22808	DWG NUMBER: A02	ORIGINAL SIZE: A3
DESIGNED BY: A.N.	DATE: 03.02.2023	
DRAWN BY: A.N.	SCALE: AS SHOWN	

3/02/2023 2:49:59 PM

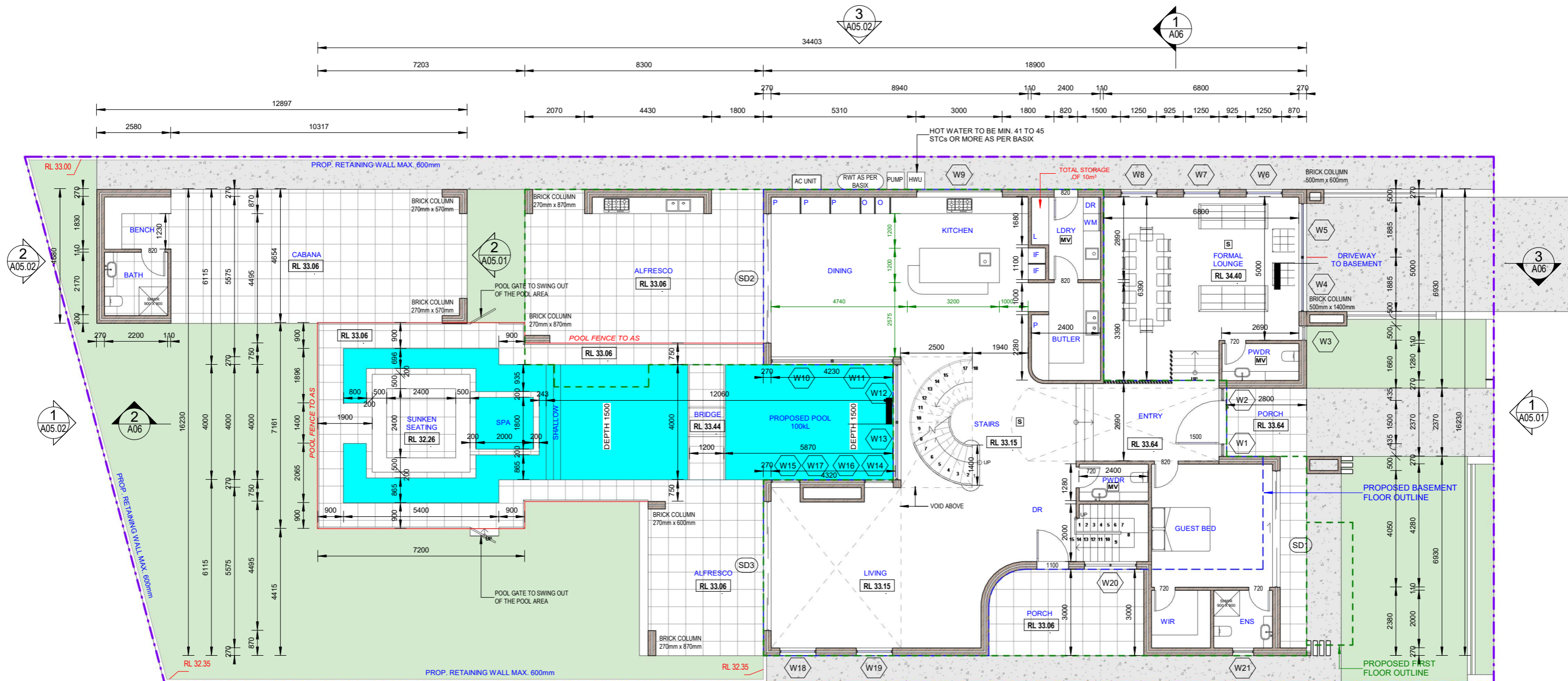

- NOTES:
1. Required pool dimensions to be confirmed on site by builder.
 2. Proposed pool to comply with AS 1926.1-2012.
 3. Pool backwash to be connected to sewer.
 4. Pool gates with child resistant barrier.
 5. Pool gates to open away from pool area.
 6. Pool fencing to be non-combustible.
 7. Boundary fence (acting as pool barrier) to be min. 1.80m high from the level of pool decking. No footholds on the barrier.

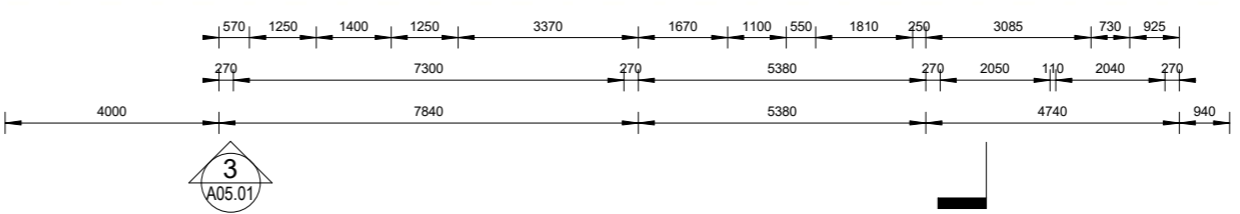

1 PROPOSED GROUND FLOOR PLAN
1: 100

- S SMOKE ALARM SYSTEM
- MV MECHANICAL VENTILATION
- PROPOSED BASEMENT FLOOR OUTLINE
- PROPOSED FIRST FLOOR OUTLINE

REV	DATE	DESCRIPTION	BY
A	03.02.2023	ISSUED FOR DA	DK

COPYRIGHT
All rights reserved.
These drawings, plans and specifications and the copyright are the property of Nemco Design and must not be used, reproduced or copied wholly or in part without the written permission of Nemco Design.

NEMCO DESIGN
PTY LTD
STRUCTURAL ENGINEERING & ARCHITECTURAL DESIGN

ADDRESS:
SUITE 4 LEVEL 1,
402-410 CHAPEL RD, BANKSTOWN,
NSW 2209
P: 9709 5566 M: 9422 696 228
E: alan@nemcodesign.com.au

PROPOSED TWO STOREY DWELLING WITH BASEMENT & POOL		JOB NUMBER: 22808	DWG NUMBER: A03	ORIGINAL SIZE: A3
50 CHASELING ST, GREENACRE LOT 75, DP 35156		DESIGNED BY: A.N.	DATE: 03.02.2023	
PROPOSED GROUND FLOOR PLAN		DRAWN BY: A.N.	SCALE: AS SHOWN	

3/02/2023 2:50:00 PM

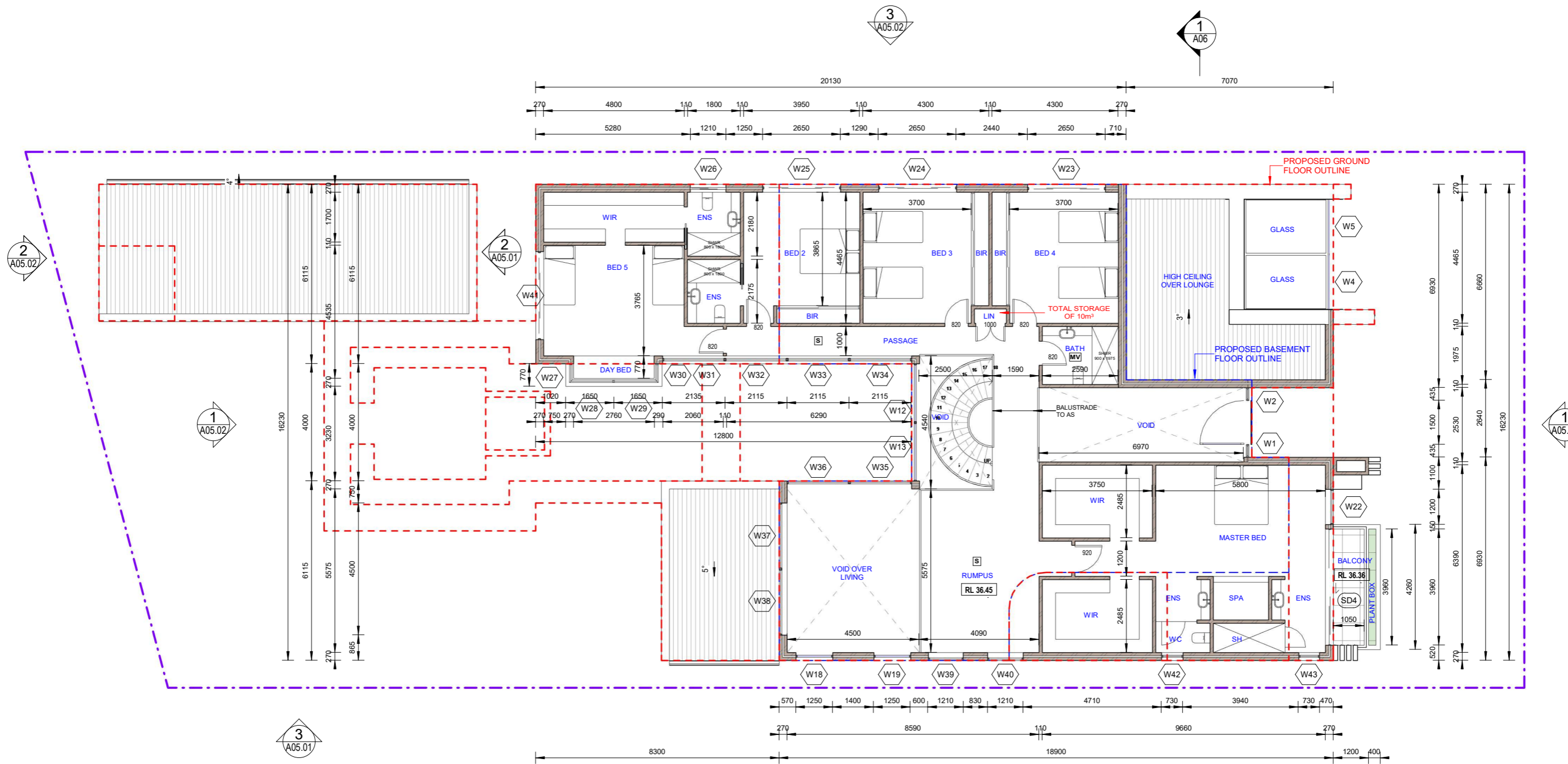

1 PROPOSED FIRST FLOOR PLAN
 1 : 100

- S SMOKE ALARM SYSTEM
- MV MECHANICAL VENTILATION
- PROPOSED BASEMENT FLOOR OUTLINE
- PROPOSED GROUND FLOOR OUTLINE

REV	DATE	DESCRIPTION	BY
A	03.02.2023	ISSUED FOR DA	DK

COPYRIGHT
 All rights reserved.
 These drawings, plans and specifications and the copyright are the property of Nemco Design and must not be used, reproduced or copied wholly or in part without the written permission of Nemco Design.

NEMCO DESIGN
 PTY LTD
 STRUCTURAL ENGINEERING & ARCHITECTURAL DESIGN

ADDRESS:
 SUITE 4 LEVEL 1,
 402-410 CHAPEL RD, BANKSTOWN,
 NSW 2209
 P: 9709 5566 M: 9422 696 229
 E: alan@nemcodesign.com.au

PROPOSED TWO STOREY DWELLING WITH BASEMENT & POOL
 50 CHASELING ST, GREENACRE
 LOT 75, DP 35156

PROPOSED FIRST FLOOR PLAN

JOB NUMBER: 22808	DWG NUMBER: A04	ORIGINAL SIZE: A3
DESIGNED BY: A.N.	DATE: 03.02.2023	
DRAWN BY: A.N.	SCALE: AS SHOWN	

3/02/2023 2:50:01 PM